



PROPOSED LOT YIELD	
STANDARD LOTS	399
SUPER LOTS	6
TOTAL	405

**NOTES:**

1. AREAS AND DIMENSIONS ARE SUBJECT TO FINAL SURVEY & COUNCIL APPROVAL
2. LOT NUMBERS SHOWN MAY CHANGE TO REFLECT STAGING OF THE SUBDIVISION

NO	REVISION	DATE	BY	CHKD	DESCRIPTION
5	AMEND TITLE BLOCK				
4	SUBMITTAL LAYOUT UPDATED TO ALIGN WITH ROAD DESIGN	28/07/2013	AM	JB	
3	LOT NUMBERS ADDED	28/07/2013	AM	JB	
2	NORTH WEST LOTS MOVED TO INTERSECT CROWN ROAD	28/07/2013	AM	JB	
1					

**MJP Montleath & Powys**  
 SURVEYING  
 ENGINEERING DESIGN  
 PROJECT MANAGEMENT

125 Bala Street Newcastle NSW 2090  
 T 61 2 4923 3388 F 61 2 4923 3389  
 E [enquiries@montleathpowys.com.au](mailto:enquiries@montleathpowys.com.au)  
 W [www.montleathpowys.com.au](http://www.montleathpowys.com.au)

Author	AM	Checked	JB	Drawn	AM	Scale	AS1	Proj No	1203166_06	Date	18/02/2013
Project	COAL & ALLIED PLAN OF PROPOSED SUBDIVISION KANANGRA DRIVE, GWANIDALAN										
Sheet No	1/6										
Revision	6										





400

ANGOPHORA  
INOPINA  
RESERVE

SEE SHEET 3

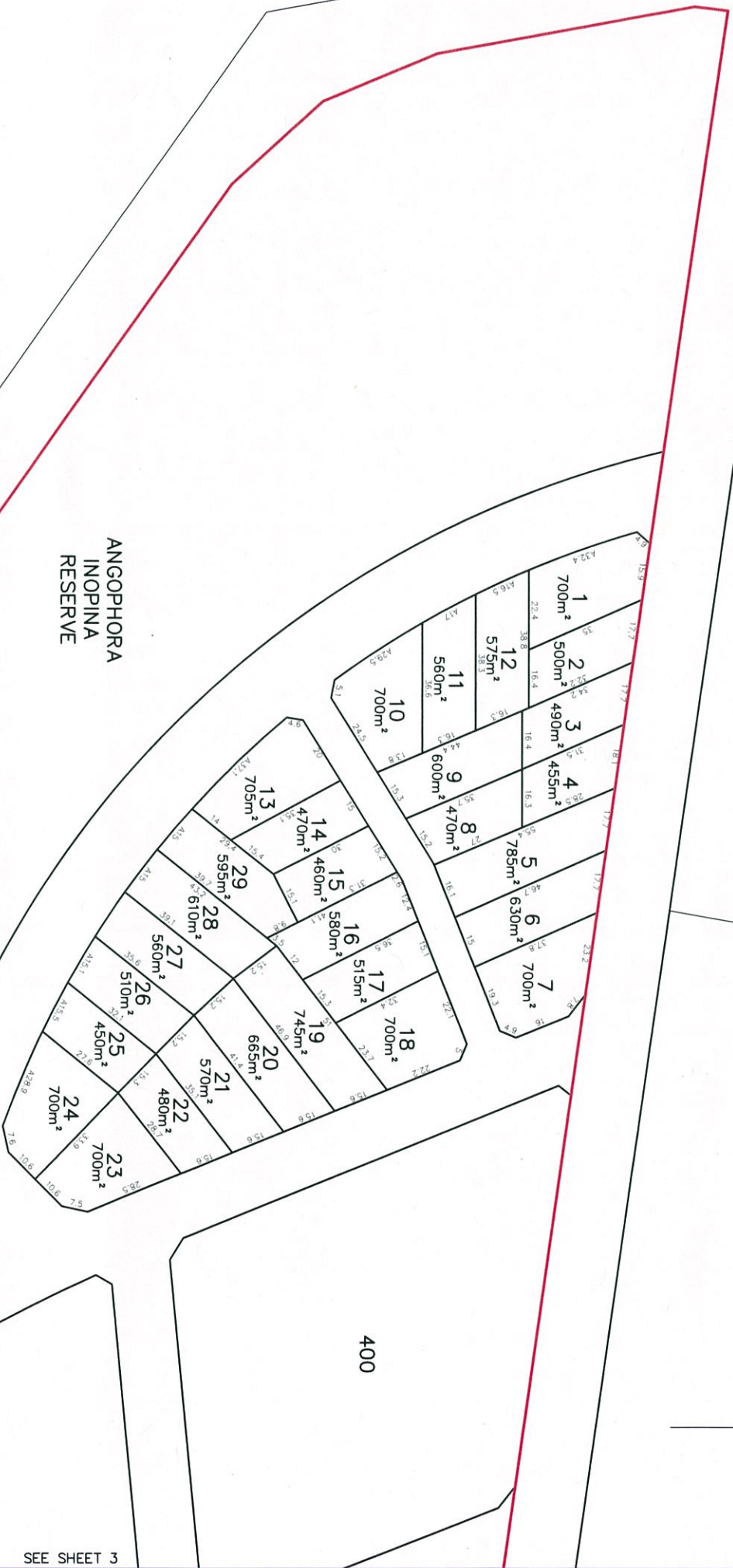

- NOTES:**
1. AREAS AND DIMENSIONS ARE SUBJECT TO FINAL SURVEY & COUNCIL APPROVAL
  2. LOT NUMBERS SHOWN MAY CHANGE TO REFLECT STAGING OF THE SUBDIVISION

NO.	REVISION	BY	DATE	DESCRIPTION
6	AMEND TITLE BLOCK	SB	19/11/13	COMPROMISE NOTICE
5	SUBDIVISION LAYOUT UPDATED TO ALIGN WITH ROAD DESIGN	SB	11/10/13	COMPROMISE NOTICE
4	LOT NUMBERS ADDED	SB	09/07/13	COMPROMISE NOTICE
3	LOT AMENDMENTS	AM	05/06/13	COMPROMISE NOTICE
2	ADJUSTMENT LOTS MOVED TO INTERSECT CHORAL ROAD	AM	05/06/13	COMPROMISE NOTICE
1	REVISION	SB	05/06/13	COMPROMISE NOTICE

**Monteath & Powys**  
 SURVEYING  
 PLANNING  
 ENGINEERING DESIGN  
 PROJECT MANAGEMENT

125 Adelaide Street, Melbourne, NSW 2200  
 Tel: 02 929 8888  
 Fax: 02 929 8889  
 Email: info@monteathpowys.com.au  
 Website: www.monteathpowys.com.au

Surveyed	Checked	Client
AM	JB	COAL & ALLIED
Scale: 1:1000	Original Scale	PLAN OF PROPOSED SUBDIVISION KANANGRA DRIVE, GWANDALAN
DO NOT SCALE	A1	CAD File: 120316_06
		Ref No: 120316
		Date: 18/02/2013
		Sheet No: 2/6
		Revision: 6



MGA



SEE SHEET 2

402

401

403

404

405

DRAINAGE RESERVE / OPEN SPACE

DRAINAGE RESERVE

DRAINAGE RESERVE

SEE SHEET 5

**NOTES:**

1. AREAS AND DIMENSIONS ARE SUBJECT TO FINAL SURVEY & COUNCIL APPROVAL
2. LOT NUMBERS SHOWN MAY CHANGE TO REFLECT STAGING OF THE SUBDIVISION

NO.	REVISION	DATE
1	AMEND TITLE BLOCK	08/08/18
2	SUBDIVISION LAYOUT UPDATED TO ALIGN WITH ROAD DESIGN	08/08/18
3	LOT NUMBERS ADDED	08/08/18
4	LOT AMENDMENTS	08/08/18
5	NORTHWEST CORNER MOVED TO INTERSECT CORNER ROAD	08/08/18

**Monteath & Powys**

125, Bal Street, Newcastle NSW 2200  
 T: 02 4929 2700  
 F: 02 4929 2701  
 E: survey@monteathpowys.com.au  
 W: www.monteathpowys.com.au

Checked	Drawn	Surveyed
JB	AM	AM

PROJECT MANAGER

REGISTERED SUBDIVISION  
 Scale: 1:1000  
 DO NOT SCALE

Original Size

Scale: A1

CAD File: 120316G\_06

Ref No: 120316

Date: 18/02/2013

Sheet No: 3/6

Revision: 6



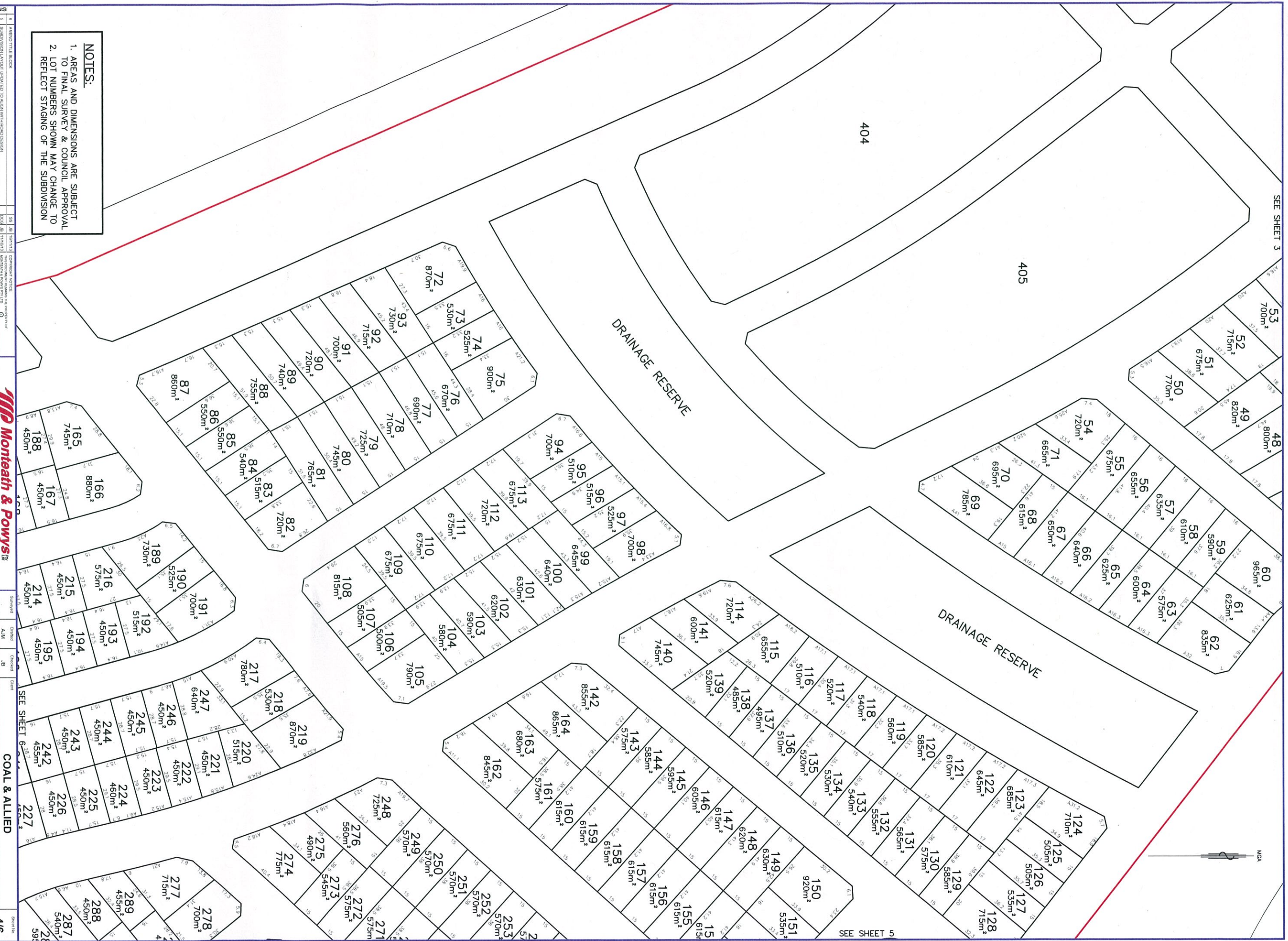

**NOTES:**  
 1. AREAS AND DIMENSIONS ARE SUBJECT TO FINAL SURVEY & COUNCIL APPROVAL  
 2. LOT NUMBERS SHOWN MAY CHANGE TO REFLECT STAGING OF THE SUBDIVISION

1	REVISION	DATE	BY	DESCRIPTION
2	REVISION			
3	REVISION			
4	REVISION			
5	REVISION			
6	REVISION			

NO.	DATE	BY	DESCRIPTION
1	18/02/2013	AM	ISSUED FOR TENDERS
2	18/02/2013	AM	ISSUED FOR TENDERS
3	18/02/2013	AM	ISSUED FOR TENDERS
4	18/02/2013	AM	ISSUED FOR TENDERS
5	18/02/2013	AM	ISSUED FOR TENDERS
6	18/02/2013	AM	ISSUED FOR TENDERS

  

NO.	DATE	BY	DESCRIPTION
1	18/02/2013	AM	ISSUED FOR TENDERS
2	18/02/2013	AM	ISSUED FOR TENDERS
3	18/02/2013	AM	ISSUED FOR TENDERS
4	18/02/2013	AM	ISSUED FOR TENDERS
5	18/02/2013	AM	ISSUED FOR TENDERS
6	18/02/2013	AM	ISSUED FOR TENDERS

**Monteath & Powys**  
 ENGINEERING DESIGN  
 PROJECT MANAGEMENT

**COAL & ALLIED**  
 PLAN OF PROPOSED SUBDIVISION  
 KANANGRA DRIVE, GWAMDALAN



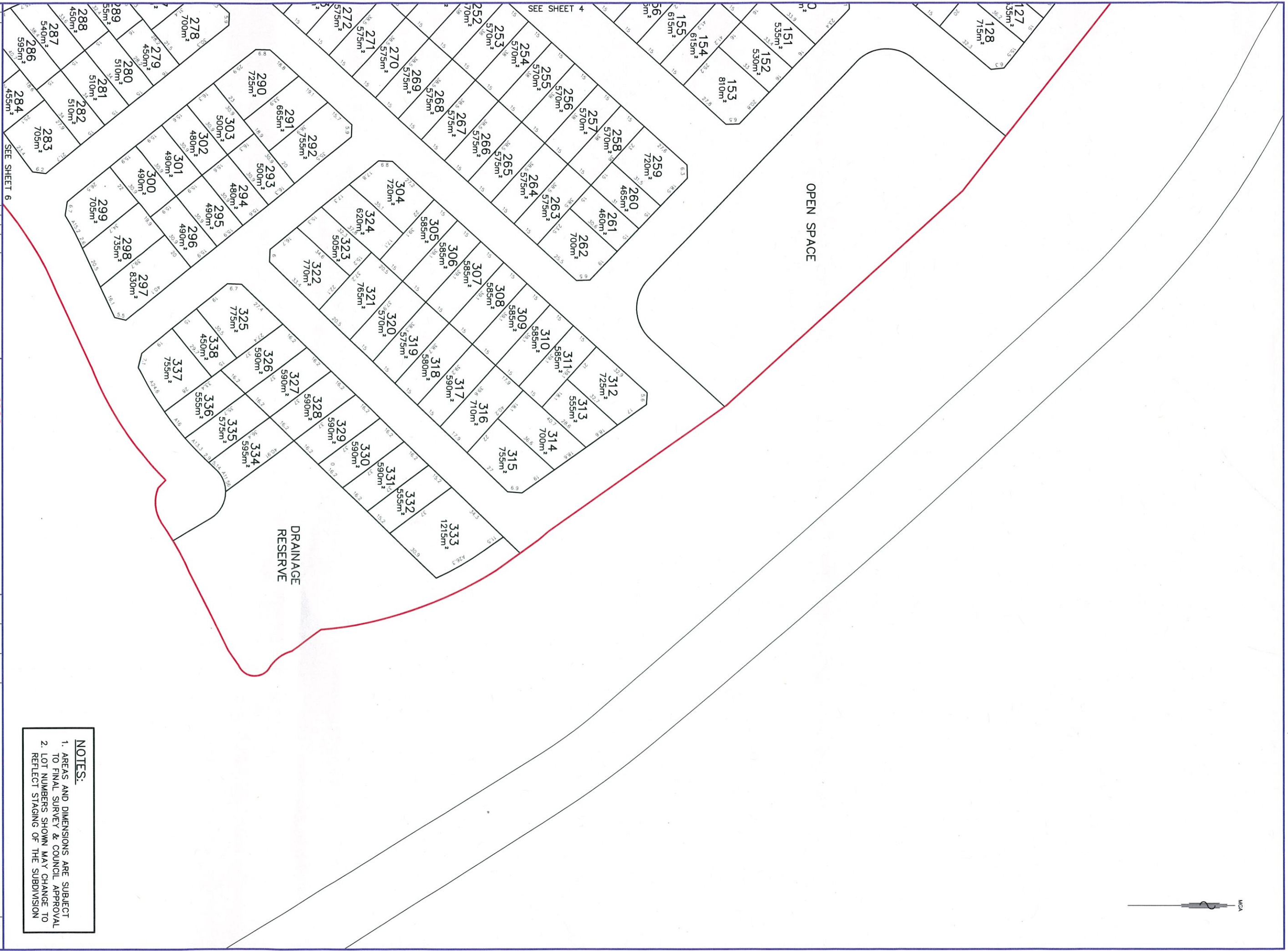

**NOTES:**

1. AREAS AND DIMENSIONS ARE SUBJECT TO FINAL SURVEY & COUNCIL APPROVAL
2. LOT NUMBERS SHOWN MAY CHANGE TO REFLECT STAGING OF THE SUBDIVISION

REVISIONS		NO.	DESCRIPTION	DATE
1	REVISION			
2	REVISION			
3	REVISION			
4	REVISION			
5	REVISION			
6	REVISION			

NO.	DESCRIPTION	DATE
1	PRELIMINARY DESIGN	18/02/2013
2	REVISED DESIGN	18/02/2013
3	REVISED DESIGN	18/02/2013
4	REVISED DESIGN	18/02/2013
5	REVISED DESIGN	18/02/2013
6	REVISED DESIGN	18/02/2013

NO.	DESCRIPTION	DATE
1	PRELIMINARY DESIGN	18/02/2013
2	REVISED DESIGN	18/02/2013
3	REVISED DESIGN	18/02/2013
4	REVISED DESIGN	18/02/2013
5	REVISED DESIGN	18/02/2013
6	REVISED DESIGN	18/02/2013

NO.	DESCRIPTION	DATE
1	PRELIMINARY DESIGN	18/02/2013
2	REVISED DESIGN	18/02/2013
3	REVISED DESIGN	18/02/2013
4	REVISED DESIGN	18/02/2013
5	REVISED DESIGN	18/02/2013
6	REVISED DESIGN	18/02/2013

**Monteath & Powys**

**COAL & ALLIED**  
 PLAN OF PROPOSED SUBDIVISION  
 KANANGRA DRIVE, GWANDALAN







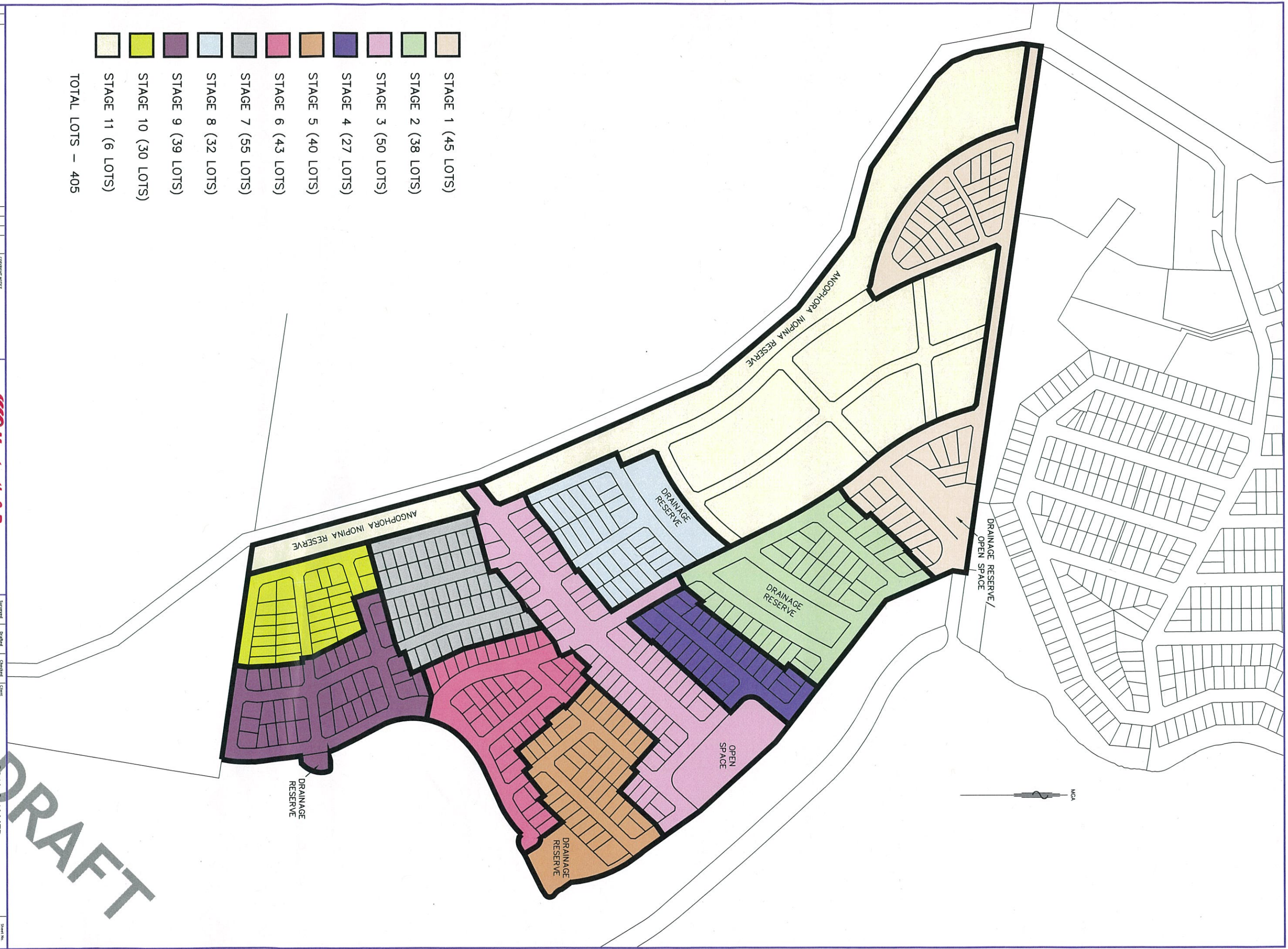

- STAGE 1 (45 LOTS)
  - STAGE 2 (38 LOTS)
  - STAGE 3 (50 LOTS)
  - STAGE 4 (27 LOTS)
  - STAGE 5 (40 LOTS)
  - STAGE 6 (43 LOTS)
  - STAGE 7 (55 LOTS)
  - STAGE 8 (32 LOTS)
  - STAGE 9 (39 LOTS)
  - STAGE 10 (30 LOTS)
  - STAGE 11 (6 LOTS)
- TOTAL LOTS – 405

REVISIONS		DATE		BY	
1	ISSUED TO CLIENT AS DRAFT				

<p><small>COPYRIGHT NOTICE: THIS PLAN IS THE PROPERTY OF MONTATH &amp; POWYS PTY LTD. NO PART OF THIS PLAN MAY BE REPRODUCED OR TRANSMITTED IN ANY FORM OR BY ANY MEANS, ELECTRONIC OR MECHANICAL, INCLUDING PHOTOCOPYING, RECORDING, OR BY ANY INFORMATION STORAGE AND RETRIEVAL SYSTEM, WITHOUT THE WRITTEN PERMISSION OF MONTATH &amp; POWYS PTY LTD.</small></p>	<p><small>PROJECT MANAGER PO Box 238 Gwandalan NSW 2330 T 61 2 4924 1388 F 61 2 4924 1405 E <a href="mailto:montath@montathpowys.com.au">montath@montathpowys.com.au</a></small></p>
--	--

<p><b>Montath &amp; Powys</b> ENGINEERING DESIGN 133 BAY ST, NEWCASTLE NSW 2300 T 61 2 4924 1388 F 61 2 4924 1405 E <a href="mailto:montath@montathpowys.com.au">montath@montathpowys.com.au</a></p>	<p><b>COAL &amp; ALLIED</b> INDICATIVE STAGING PLAN KANARRGA DRIVE, GWANDALAN Ref No: 120316 Date: 15/11/2013</p>	<p>Surveyed: <input type="checkbox"/>    Drafted: <input type="checkbox"/>    Checked: <input type="checkbox"/></p> <p>Drawn: A.M.    Client: J.B.</p> <p>Scale: A1: 1:5000    Original Size: A1</p> <p>DO NOT SCALE</p> <p>CAD FILE: 120316R_01</p>
--	---	--

Sheet No: 1/1	Revision: 1
---------------	-------------